

BD 13

Scaldasalviette in acciaio al carbonio costituito da elementi tubolari dal diametro di 13 mm.

Disponibile in diverse dimensioni, oltre 200 variabili cromatiche e anche cromo e oro.

Towel warmer made of tubular, carbon steel elements (diameter 13 mm).

Comes in various sizes and in more than 200 colours, even chrome and gold.

Handtuchwärmer aus Kohlenstoffstahl, bestehend aus Rundrohren mit einem Durchmesser von 13 mm. In verschiedenen Größen und über 200 Farbtönen erhältlich, auch goldfarben und in Chrom.

Radiateur sèche-serviettes en acier au carbone constitué d'éléments tubulaires de 13 mm de diamètre. Disponible en différentes dimensions, plus de 200 variantes chromatiques ainsi qu'en chromé et doré.

Calentador de toallas en acero al carbono formado por elementos tubulares de 13 mm de diámetro. Se encuentra disponible en diversos tamaños además de 200 variantes cromáticas e incluso cromo y oro.





Bath / BD 13
188 x 40 cm
WATT ΔT 50° [572]
COLOR : CROM

INFORMAZIONI TECNICHE / TECHNICAL DETAILS / DONNÉES
TECHNIQUES / TECHNISCHE DATEN / INFORMACIONES TÉCNICAS
PAGE 281



Bath / BD13d
152 x 60 cm
WATT ΔT 50° [1504]
COLOR : BIAN

INFORMAZIONI TECNICHE / TECHNICAL DETAILS/ DONNÉES
TECHNIQUES / TECHNISCHE DATEN / INFORMACIONES TÉCNICAS
PAGE 283

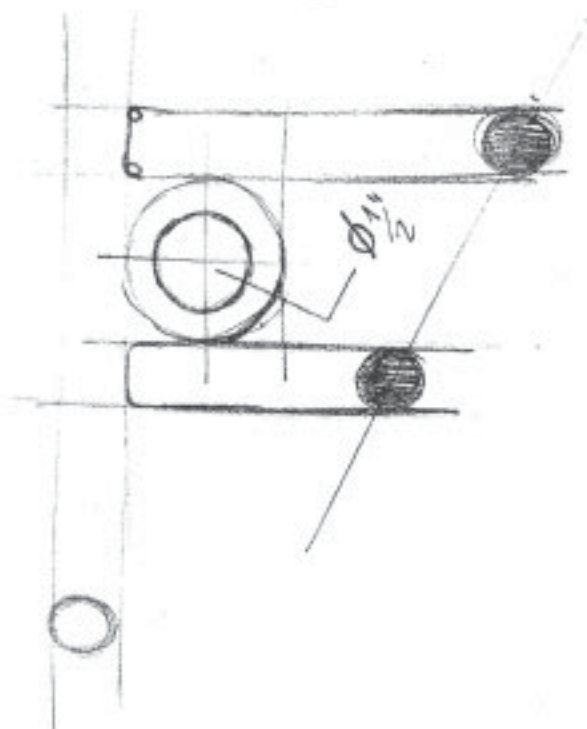

STBOS min.10
max.70

$B^* \leq 90$

min.13
max.20

STBOP min.6

$B^* \leq 60$

STBOPV min.13

$B^* \leq 60$

$l^* = A^* - 5,8 \text{ cm}$

BD I3S

9,1
6,3 / 7,7

[A] attacco standard
standard connection
raccord standard
standard Anschluss
conexión estándar

[B] attacco speciale
special connection
raccord spéciale
speziell Anschluss
conexión especial

P* 296

A* cm	in	B* cm	in	l* cm	in	art*	BTU Δt 50°	watt Δt 50°	E* M* ET* MT*
80.0	31.5	40.0	15.7	36.0	14.2	BD13000S080040	1 322	388	350
80.0	31.5	50.0	19.7	46.0	18.1	BD13000S080050	1 650	484	500
80.0	31.5	60.0	23.6	56.0	22.0	BD13000S080060	1 973	579	500
80.0	31.5	70.0	27.6	66.0	26.0	BD13000S080070	2 295	673	
80.0	31.5	80.0	31.5	76.0	29.9	BD13000S080080	2 616	767	
80.0	31.5	90.0	35.4	86.0	33.9	BD13000S080090	2 937	861	
80.0	31.5	100.0	39.4	96.0	37.8	BD13000S080100	3 285	963	
116.0	45.7	40.0	15.7	36.0	14.2	BD13000S116040	1 844	541	500
116.0	45.7	50.0	19.7	46.0	14.2	BD13000S116050	2 296	673	700
116.0	45.7	60.0	23.6	56.0	14.2	BD13000S116060	2 745	805	700
116.0	45.7	70.0	27.6	66.0	14.2	BD13000S116070	3 193	937	
116.0	45.7	80.0	31.5	76.0	14.2	BD13000S116080	3 641	1 068	
116.0	45.7	90.0	35.4	86.0	14.2	BD13000S116090	4 087	1 198	
116.0	45.7	100.0	39.4	96.0	14.2	BD13000S116100	4 532	1 329	
152.0	59.8	40.0	15.7	36.0	14.2	BD13000S152040	2 351	690	700
152.0	59.8	50.0	19.7	46.0	14.2	BD13000S152050	2 926	858	700
152.0	59.8	60.0	23.6	56.0	14.2	BD13000S152060	3 500	1 026	1000
152.0	59.8	70.0	27.6	66.0	14.2	BD13000S152070	4 071	1 194	
152.0	59.8	80.0	31.5	76.0	14.2	BD13000S152080	4 641	1 361	
152.0	59.8	90.0	35.4	86.0	14.2	BD13000S152090	5 210	1 528	
152.0	59.8	100.0	39.4	96.0	14.2	BD13000S152100	5 777	1 694	
188.0	74.0	40.0	15.7	36.0	14.2	BD13000S188040	2 913	854	700
188.0	74.0	50.0	19.7	46.0	14.2	BD13000S188050	3 549	1 041	1000
188.0	74.0	60.0	23.6	56.0	14.2	BD13000S188060	4 244	1 245	1000
188.0	74.0	70.0	27.6	66.0	14.2	BD13000S188070	4 937	1 448	
188.0	74.0	80.0	31.5	76.0	14.2	BD13000S188080	5 629	1 651	
188.0	74.0	90.0	35.4	86.0	14.2	BD13000S188090	6 318	1 853	
188.0	74.0	100.0	39.4	96.0	14.2	BD13000S188100	6 906	2 025	

art	watt	E*	art	watt	ET*
SOVRES0350	350		SOVRES0350 T	350	
SOVRES0500	500		SOVRES0500 T	500	
SOVRES0700	700		SOVRES0700 T	700	
SOVRES1000	1000		SOVRES1000 T	1000	
KITRES0350	350		KITRES0350 T	350	
KITRES0500	500		KITRES0500 T	500	
KITRES0700	700		KITRES0700 T	700	
KITRES1000	1000		KITRES1000 T	1000	

A* = altezza / height / hauteur / Höhe / alto B* = larghezza / width / longueur / Breite / ancho art* = articolo / model / modèle / Artikel / artículo
 l* = interasse / pipe centres / distance entre depart et retour / Achsabstand / distancia entre las conexiones P* = pagina / page / page / Seite / página
 E* = elettrico / electrical / électric / elektrische / eléctrico M* = misto / dual application / mixte / der gemischter Ausführung / kit mixto
 ET* = elettrico termostato ambiente / thermostat / thermostat / der Thermostat / termostato
 MT* = misto termostato ambiente / dual application with thermostat / mixte avec thermostat / der gemischter Ausführung mit Thermostat / kit mixto con termostato

Kcal = Watt x 0,860
BTU = Watt x 3,413

Watt Δt 60° = Watt Δt 50° x 1,241
Watt Δt 40° = Watt Δt 50° x 0,768
Watt Δt 30° = Watt Δt 50° x 0,546
Watt Δt 20° = Watt Δt 50° x 0,338

p max = 10.0 bar

Colori/ colours / couleurs / Farbe / colores

[BIAN] B standard
T + 10%
S + 20%

[RAL] S + 20%

RAL non inclusi in tabella
special Ral colours
couleurs Ral spéciales
RAL Farbe nicht in der Tabelle inbegriffen
colores RAL especiales

Ulteriori dettagli
Further details
Ulérieures détails
Weitere Einzelheiten
Otros detalles

P* 294



BD 13s CROM

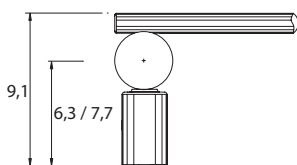

STBOS

min.10
max.70

$B^* \leq 90$

min.13
max.20

STBOP

min.6

$B^* \leq 60$

STBOPV

min.13

$B^* \leq 60$

$l^* = A^* - 5,8 \text{ cm}$

[A] attacco standard
standard connection
raccord standard
standard Anschluss
conexión estándar

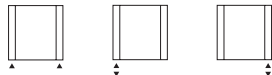

[B] attacco speciale
special connection
raccord spéciale
speziell Anschluss
conexión especial

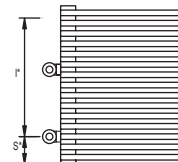

P* 296

CROM									E* M* ET* MT*		
A* cm	in	B* cm	in	l* cm	in	art*	BTU Δt 50°	watt Δt 50°			
80.0	31.5	40.0	15.7	36.0	14.2	BD13000S080040R	886	260			350
80.0	31.5	50.0	19.7	46.0	18.1	BD13000S080050R	1 105	324			500
80.0	31.5	60.0	23.6	56.0	22.0	BD13000S080060R	1 322	388			500
80.0	31.5	70.0	27.6	66.0	26.0	BD13000S080070R	1 538	451			
80.0	31.5	80.0	31.5	76.0	29.9	BD13000S080080R	1 753	514			
80.0	31.5	90.0	35.4	86.0	33.9	BD13000S080090R	1 968	577			
80.0	31.5	100.0	39.4	96.0	37.8	BD13000S080100R	2 201	645			
116.0	45.7	40.0	15.7	36.0	14.2	BD13000S116040R	1 236	362			500
116.0	45.7	50.0	19.7	46.0	14.2	BD13000S116050R	1 538	451			700
116.0	45.7	60.0	23.6	56.0	14.2	BD13000S116060R	1 839	539			700
116.0	45.7	70.0	27.6	66.0	14.2	BD13000S116070R	2 140	627			
116.0	45.7	80.0	31.5	76.0	14.2	BD13000S116080R	2 439	715			
116.0	45.7	90.0	35.4	86.0	14.2	BD13000S116090R	2 738	803			
116.0	45.7	100.0	39.4	96.0	14.2	BD13000S116100R	3 036	890			
152.0	59.8	40.0	15.7	36.0	14.2	BD13000S152040R	1 575	462			700
152.0	59.8	50.0	19.7	46.0	14.2	BD13000S152050R	1 961	575			700
152.0	59.8	60.0	23.6	56.0	14.2	BD13000S152060R	2 345	688			1 000
152.0	59.8	70.0	27.6	66.0	14.2	BD13000S152070R	2 728	800			
152.0	59.8	80.0	31.5	76.0	14.2	BD13000S152080R	3 109	912			
152.0	59.8	90.0	35.4	86.0	14.2	BD13000S152090R	3 491	1 024			
152.0	59.8	100.0	39.4	96.0	14.2	BD13000S152100R	3 871	1 135			
188.0	74.0	40.0	15.7	36.0	14.2	BD13000S188040R	1 952	572			700
188.0	74.0	50.0	19.7	46.0	14.2	BD13000S188050R	2 378	697			1000
188.0	74.0	60.0	23.6	56.0	14.2	BD13000S188060R	2 844	834			1000
188.0	74.0	70.0	27.6	66.0	14.2	BD13000S188070R	3 308	970			
188.0	74.0	80.0	31.5	76.0	14.2	BD13000S188080R	3 771	1 106			
188.0	74.0	90.0	35.4	86.0	14.2	BD13000S188090R	4 233	1 241			
188.0	74.0	100.0	39.4	96.0	14.2	BD13000S188100R	4 627	1 357			

art	watt		art	watt	
SOVRES0350	350	E*	SOVRES0350 T	350	ET*
SOVRES0500	500		SOVRES0500 T	500	
SOVRES0700	700		SOVRES0700 T	700	
SOVRES1000	1000		SOVRES1000 T	1000	
KITRES0350	350	M*	KITRES0350 T	350	MT*
KITRES0500	500		KITRES0500 T	500	
KITRES0700	700		KITRES0700 T	700	
KITRES1000	1000		KITRES1000 T	1000	

A* = altezza / height / hauteur / Höhe / alto B* = larghezza / width / longueur / Breite / ancho art* = articolo / model / modèle / Artikel / artículo
 l* = interasse / pipe centres / distance entre depart et retour / Achsabstand / distancia entre las conexiones P* = pagina / page / page / Seite / página
 E* = elettrico / electrical / électric / elektrische / eléctrico M* = misto / dual application / mixte / der gemischter Ausführung / kit mixto
 ET* = elettrico termostato ambiente / thermostat / thermostat / der Thermostat / termostato
 MT* = misto termostato ambiente / dual application with thermostat / mixte avec thermostat / der gemischter Ausführung mit Thermostat / kit mixto con termostato



Ulteriori dettagli
Further details
Ulérieures détails
Weitere Einzelheiten
Otros detalles

P* 294

Kcal = Watt x 0,860
BTU = Watt x 3,413

Watt Δt 60° = Watt Δt 50° x 1,241
 Watt Δt 40° = Watt Δt 50° x 0,768
 Watt Δt 30° = Watt Δt 50° x 0,546
 Watt Δt 20° = Watt Δt 50° x 0,338

p max = 10.0 bar

STBOS min.10 max.70
B* ≤ 60

STBOP min.6
B* ≤ 40

STBOPV min.13
B* ≤ 40
I* = A* - 5,8 cm

BD 13d

[A] attacco standard
standard connection
raccord standard
standard Anschluss
conexión estándar

[B] attacco speciale
special connection
raccord spéciale
speziell Anschluss
conexión especial

P* 296

A* cm	in	B* cm	in	I* cm	in	art*	BTU Δt 50°	watt Δt 50°
80.0	31.5	40.0	15.7	36.0	14.2	BD13000D080040	2 080	610
80.0	31.5	50.0	19.7	46.0	18.1	BD13000D080050	2 596	761
80.0	31.5	60.0	23.6	56.0	22.0	BD13000D080060	3 108	912
80.0	31.5	70.0	27.6	66.0	26.0	BD13000D080070	3 624	1 063
80.0	31.5	80.0	31.5	76.0	29.9	BD13000D080080	4 140	1 214
80.0	31.5	90.0	35.4	86.0	33.9	BD13000D080090	4 655	1 365
80.0	31.5	100.0	39.4	96.0	37.8	BD13000D080100	5 171	1 516
116.0	45.7	40.0	15.7	36.0	14.2	BD13000D116040	2 790	818
116.0	45.7	50.0	19.7	46.0	18.1	BD13000D116050	3 483	1 021
116.0	45.7	60.0	23.6	56.0	22.0	BD13000D116060	4 176	1 225
116.0	45.7	70.0	27.6	66.0	26.0	BD13000D116070	4 868	1 428
116.0	45.7	80.0	31.5	76.0	29.9	BD13000D116080	5 560	1 631
116.0	45.7	90.0	35.4	86.0	33.9	BD13000D116090	6 249	1 832
116.0	45.7	100.0	39.4	96.0	37.8	BD13000D116100	6 945	2 037
152.0	59.8	40.0	15.7	36.0	14.2	BD13000D152040	3 426	1 005
152.0	59.8	50.0	19.7	46.0	18.1	BD13000D152050	4 273	1 253
152.0	59.8	60.0	23.6	56.0	22.0	BD13000D152060	5 129	1 504
152.0	59.8	70.0	27.6	66.0	26.0	BD13000D152070	5 976	1 753
152.0	59.8	80.0	31.5	76.0	29.9	BD13000D152080	6 831	2 003
152.0	59.8	90.0	35.4	86.0	33.9	BD13000D152090	7 678	2 252
152.0	59.8	100.0	39.4	96.0	37.8	BD13000D152100	8 534	2 503
188.0	74.0	40.0	15.7	36.0	14.2	BD13000D188040	4 046	1 187
188.0	74.0	50.0	19.7	46.0	18.1	BD13000D188050	5 053	1 482
188.0	74.0	60.0	23.6	56.0	22.0	BD13000D188060	6 056	1 776
188.0	74.0	70.0	27.6	66.0	26.0	BD13000D188070	7 062	2 071
188.0	74.0	80.0	31.5	76.0	29.9	BD13000D188080	8 064	2 365
188.0	74.0	90.0	35.4	86.0	33.9	BD13000D188090	9 070	2 660
188.0	74.0	100.0	39.4	96.0	37.8	BD13000D188100	10 072	2 954

A* = altezza / height / hauteur / Höhe / alto
I* = interasse / pipe centres / distance entre depart et retour / Achsabstand / distancia entre las conexiones

art* = articolo / model / modèle / Artikel / artículo
P* = pagina / page / page / Seite / página

Kcal = Watt x 0,860
BTU = Watt x 3,413

Watt Δt 60° = Watt Δt 50° x 1,264
Watt Δt 40° = Watt Δt 50° x 0,750
Watt Δt 30° = Watt Δt 50° x 0,518
Watt Δt 20° = Watt Δt 50° x 0,307

p max = 10.0 bar

Colori/ colours / couleurs / Farbe / colores

[BIAN] B standard
T + 10%
S + 20%

[RAL] S + 20%
RAL non inclusi in tabella
special Ral colours
couleurs Ral spéciales
RAL Farbe nicht in der Tabelle inbegriffen
colores RAL especiales

Ulteriori dettagli
Further details
Ultérieures détails
Weitere Einzelheiten
Otros detalles



P* 294