

BD 25

Scaldasalviette in acciaio al carbonio costituito da elementi tubolari dal diametro di 25 mm. Disponibile in diverse dimensioni, oltre 200 varianti cromatiche e anche cromo e oro.

Towel warmer made of tubular, carbon steel elements (diameter 25 mm). Comes in various sizes and in more than 200 colours, even chrome and gold.

Handtuchwärmer aus Kohlenstoffstahl, bestehend aus Rundrohren mit einem Durchmesser von 25 mm. In verschiedenen Größen und über 200 Farbtönen erhältlich, auch goldfarben und in Chrom.

Radiateur sèche-serviettes en acier au carbone constitué d'éléments tubulaires de 25 mm de diamètre. Disponible dans d'autres dimensions, plus de 200 variantes chromatiques ainsi qu'en chromé et doré.

Calentador de toallas en acero al carbono formado por elementos tubulares de 25 mm de diámetro. Se encuentra disponible en diversos tamaños, más de 200 variantes cromáticas e incluso cromo y oro.





Bath / BD25
152 x 40 CM
WATT ΔT 50° [488]
COLOR : CROM

INFORMAZIONI TECNICHE / TECHNICAL DETAILS / DONNÉES
TECHNIQUES / TECHNISCHE DATEN / INFORMACIONES TÉCNICAS
PAGE 284

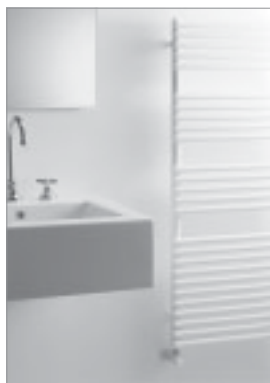

BD 25s

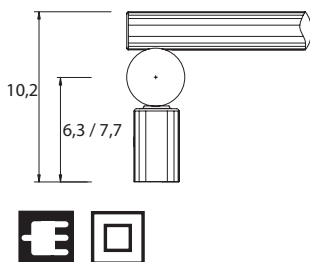

STBOS

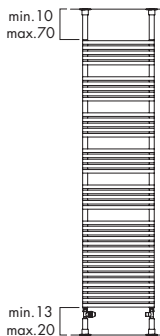

$B^* \leq 90$

STBOP

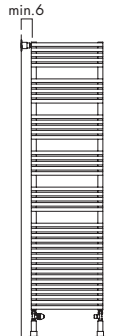

$B^* \leq 60$

STBOPV

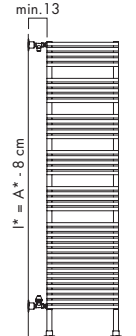

$B^* \leq 60$

[A] attacco standard
standard connection
raccord standard
standard Anschluss
conexión estándar

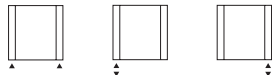

[B] attacco speciale
special connection
raccord spéciale
speziell Anschluss
conexión especial

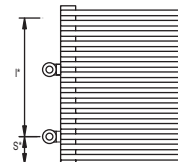

P* 296

A* cm	in	B* cm	in	I* cm	in	art*	BTU Δt 50°	watt Δt 50°	E* M* ET* MT*
80.0	31.5	40.0	15.7	36.0	14.2	BD25000S080040	1 242	365	350
80.0	31.5	50.0	19.7	46.0	18.1	BD25000S080050	1 552	455	500
80.0	31.5	60.0	23.6	56.0	22.0	BD25000S080060	1 846	541	500
80.0	31.5	70.0	27.6	66.0	26.0	BD25000S080070	2 138	626	
80.0	31.5	80.0	31.5	76.0	29.9	BD25000S080080	2 428	712	
80.0	31.5	90.0	35.4	86.0	33.9	BD25000S080090	2 716	797	
80.0	31.5	100.0	39.4	96.0	37.8	BD25000S080100	3 033	889	
116.0	45.7	40.0	15.7	36.0	14.2	BD25000S116040	1 786	524	500
116.0	45.7	50.0	19.7	46.0	14.2	BD25000S116050	2 209	648	700
116.0	45.7	60.0	23.6	56.0	14.2	BD25000S116060	2 628	771	700
116.0	45.7	70.0	27.6	66.0	14.2	BD25000S116070	3 044	896	
116.0	45.7	80.0	31.5	76.0	14.2	BD25000S116080	3 457	1 014	
116.0	45.7	90.0	35.4	86.0	14.2	BD25000S116090	3 686	1 134	
116.0	45.7	100.0	39.4	96.0	14.2	BD25000S116100	4 276	1 254	
152.0	59.8	40.0	15.7	36.0	14.2	BD25000S152040	2 297	674	700
152.0	59.8	50.0	19.7	46.0	14.2	BD25000S152050	2 842	833	700
152.0	59.8	60.0	23.6	56.0	14.2	BD25000S152060	3 381	992	1000
152.0	59.8	70.0	27.6	66.0	14.2	BD25000S152070	3 916	1 148	
152.0	59.8	80.0	31.5	76.0	14.2	BD25000S152080	4 447	1 304	
152.0	59.8	90.0	35.4	86.0	14.2	BD25000S152090	4 975	1 459	
152.0	59.8	100.0	39.4	96.0	14.2	BD25000S152100	5 501	1 613	
188.0	74.0	40.0	15.7	36.0	14.2	BD25000S188040	2 840	833	700
188.0	74.0	50.0	19.7	46.0	14.2	BD25000S188050	3 449	1 012	1000
188.0	74.0	60.0	23.6	56.0	14.2	BD25000S188060	4 104	1 203	1000
188.0	74.0	70.0	27.6	66.0	14.2	BD25000S188070	4 753	1 394	
188.0	74.0	80.0	31.5	76.0	14.2	BD25000S188080	5 398	1 583	
188.0	74.0	90.0	35.4	86.0	14.2	BD25000S188090	6 039	1 771	
188.0	74.0	100.0	39.4	96.0	14.2	BD25000S188100	6 554	1 922	

art	watt	E*	M*	ET*	MT*
SOVRES0350	350				
SOVRES0500	500				
SOVRES0700	700				
SOVRES1000	1000				
KITRES0350	350				
KITRES0500	500				
KITRES0700	700				
KITRES1000	1000				

A* = altezza / height / hauteur / Höhe / alto B* = larghezza / width / longueur / Breite / ancho art* = articolo / model / modèle / Artikel / artículo
 I* = interasse / pipe centres / distance entre depart et retour / Achsabstand / distancia entre las conexiones P* = pagina / page / page / Seite / pági
 E* = elettrico / electrical / électric / elektrische / eléctrico M* = misto / dual application / mixte / der gemischter Ausführung / kit mixto
 ET* = elettrico termostato ambiente / thermostat / thermostat / der Thermostat / termostato
 MT* = misto termostato ambiente / dual application with thermostat / mixte avec thermostat / der gemischter Ausführung mit Thermostat / kit mixto con termostato

	Ulteriori dettagli Further details Ulérieures détails Weitere Einzelheiten Otros detalles	Colori/ colours / couleurs / Farbe / colores [BIAN] B standard T + 10% S + 20% [RAL] S + 20% RAL non inclusi in tabella special Ral colours couleurs Ral spéciales RAL Farbe nicht in der Tabelle inbegriffen colores RAL especiales	Kcal = Watt x 0,860 BTU = Watt x 3,413 Watt Δt 60° = Watt Δt 50° x 1,238 Watt Δt 40° = Watt Δt 50° x 0,770 Watt Δt 30° = Watt Δt 50° x 0,550 Watt Δt 20° = Watt Δt 50° x 0,342 p max = 10.0 bar
	P* 294		

BD 25s CROM

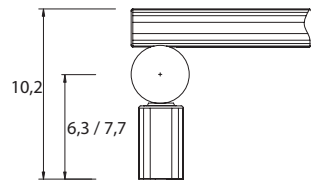

[A] attacco standard
standard connection
raccord standard
standard Anschluss
conexión estándar

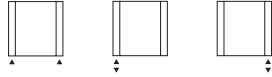

[B] attacco speciale
special connection
raccord spéciale
speziell Anschluss
conexión especial

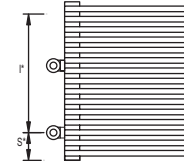

P* 296

CROM												
A* cm	in	B* cm	in	I* cm	in	art*	BTU Δt 50°	watt Δt 50°	E*	M*	ET*	MT*
80.0	31.5	40.0	15.7	36.0	14.2	BD25000S080040R	906	265	-			
80.0	31.5	50.0	19.7	46.0	18.1	BD25000S080050R	1 129	331	350			
80.0	31.5	60.0	23.6	56.0	22.0	BD25000S080060R	1 343	393	350			
116.0	45.7	40.0	15.7	36.0	14.2	BD25000S116040R	1 297	380	350			
116.0	45.7	50.0	19.7	46.0	18.1	BD25000S116050R	1 604	470	500			
116.0	45.7	60.0	23.6	56.0	22.0	BD25000S116060R	1 908	559	500			
152.0	59.8	40.0	15.7	36.0	14.2	BD25000S152040R	1 665	488	500			
152.0	59.8	50.0	19.7	46.0	18.1	BD25000S152050R	2 058	603	500			
152.0	59.8	60.0	23.6	56.0	22.0	BD25000S152060R	2 451	718	700			
188.0	74.0	40.0	15.7	36.0	14.2	BD25000S188040R	2 056	602	500			
188.0	74.0	50.0	19.7	46.0	18.1	BD25000S188050R	2 498	732	700			
188.0	74.0	60.0	23.6	56.0	22.0	BD25000S188060R	2 969	870	700			

art	watt			art	watt		
SOVRES0350	350	E*		SOVRES0350 T	350	ET*	
SOVRES0500	500			SOVRES0500 T	500		
SOVRES0700	700			SOVRES0700 T	700		
SOVRES1000	1000			SOVRES1000 T	1000		
KITRES0350	350	M*		KITRES0350 T	350	MT*	
KITRES0500	500			KITRES0500 T	500		
KITRES0700	700			KITRES0700 T	700		
KITRES1000	1000			KITRES1000 T	1000		

A* = altezza / height / hauteur / Höhe / alto **B*** = larghezza / width / longueur / Breite / ancho **art*** = articolo / model / modèle / Artikel / artículo
I* = interasse / pipe centres / distance entre depart et retour / Achsstand / distancia entre las conexiones **P*** = pagina / page / page / Seite / pági
E* = elettrico / electrical / électric / elektrische / eléctrico **M*** = misto / dual application / mixte / der gemischter Ausführung / kit mixto
ET* = elettrico termostato ambiente / thermostat / thermostat / der Thermostat / termostato
MT* = misto termostato ambiente / dual application with thermostat / mixte avec thermostat / der gemischter Ausführung mit Thermostat / kit mixto con termostato

Kcal = Watt x 0,860
 BTU = Watt x 3,413

Watt Δt 60° = Watt Δt 50° x 1,238
 Watt Δt 40° = Watt Δt 50° x 0,770
 Watt Δt 30° = Watt Δt 50° x 0,550
 Watt Δt 20° = Watt Δt 50° x 0,342

p max = 10.0 bar

Ulteriori dettagli
 Further details
 Ulérieures détails
 Weitere Einzelheiten
 Otros detalles



P* 294

BD 25d

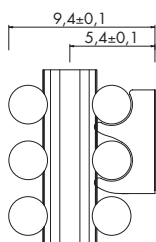

STBOS

min. 10
max. 70

$B^* \leq 60$

min. 13
max. 20

STBOP

min. 6

$B^* \leq 40$

STBOPV

min. 13

$B^* \leq 40$

$l^* = A^* - 8 \text{ cm}$

[A] attacco standard
standard connection
raccord standard
standard Anschluss
conexión estándar

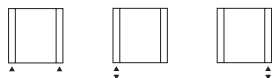

[B] attacco speciale
special connection
raccord spéciale
speziell Anschluss
conexión especial

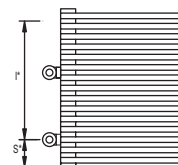

P* 296

A* cm	in	B* cm	in	l* cm	in	art*	BTU Δt 50°	watt Δt 50°
80.0	31.5	40.0	15.7	36.0	14.2	BD25000D080040	1 918	563
80.0	31.5	50.0	19.7	46.0	18.1	BD25000D080050	2 391	701
80.0	31.5	60.0	23.6	56.0	22.0	BD25000D080060	2 864	840
80.0	31.5	70.0	27.6	66.0	26.0	BD25000D080070	3 336	978
80.0	31.5	80.0	31.5	76.0	29.9	BD25000D080080	3 808	1 117
80.0	31.5	90.0	35.4	86.0	33.9	BD25000D080090	4 276	1 254
80.0	31.5	100.0	39.4	96.0	37.8	BD25000D080100	4 744	1 391
116.0	45.7	40.0	15.7	36.0	14.2	BD25000D116040	2 659	780
116.0	45.7	50.0	19.7	46.0	14.2	BD25000D116050	3 315	972
116.0	45.7	60.0	23.6	56.0	14.2	BD25000D116060	3 975	1 166
116.0	45.7	70.0	27.6	66.0	14.2	BD25000D116070	4 634	1 359
116.0	45.7	80.0	31.5	76.0	14.2	BD25000D116080	5 294	1 552
116.0	45.7	90.0	35.4	86.0	14.2	BD25000D116090	5 953	1 746
116.0	45.7	100.0	39.4	96.0	14.2	BD25000D116100	6 609	1 938
152.0	59.8	40.0	15.7	36.0	14.2	BD25000D152040	3 408	999
152.0	59.8	50.0	19.7	46.0	14.2	BD25000D152050	4 250	1 246
152.0	59.8	60.0	23.6	56.0	14.2	BD25000D152060	5 096	1 495
152.0	59.8	70.0	27.6	66.0	14.2	BD25000D152070	5 946	1 744
152.0	59.8	80.0	31.5	76.0	14.2	BD25000D152080	6 788	1 991
152.0	59.8	90.0	35.4	86.0	14.2	BD25000D152090	7 634	2 239
152.0	59.8	100.0	39.4	96.0	14.2	BD25000D152100	8 480	2 487
188.0	74.0	40.0	15.7	36.0	14.2	BD25000D188040	4 032	1 182
188.0	74.0	50.0	19.7	46.0	14.2	BD25000D188050	5 035	1 477
188.0	74.0	60.0	23.6	56.0	14.2	BD25000D188060	6 039	1 771
188.0	74.0	70.0	27.6	66.0	14.2	BD25000D188070	7 042	2 065
188.0	74.0	80.0	31.5	76.0	14.2	BD25000D188080	8 045	2 359
188.0	74.0	90.0	35.4	86.0	14.2	BD25000D188090	9 052	2 655
188.0	74.0	100.0	39.4	96.0	14.2	BD25000D188100	10 055	2 949

A* = altezza / height / hauteur / Höhe / alto B* = larghezza / width / longueur / Breite / ancho
 l* = interasse / pipe centres / distance entre depart et retour / Achsabstand / distancia entre las conexiones

art* = articolo / model / modèle / Artikel / artículo P* = pagina / page / page / Seite / página



Ulteriori dettagli
Further details
Ulérieures détails
Weitere Einzelheiten
Otros detalles

P* 294

Colori/ colours / couleurs / Farbe / colores

- [BIAN] B standard
T + 10%
S + 20%
- [RAL] S + 20%
RAL non inclusi in tabella
special Ral colours
couleurs Ral spéciales
RAL Farbe nicht in der Tabelle inbegriffen
colores RAL especiales

Kcal = Watt x 0,860
BTU = Watt x 3,413

Watt Δt 60° = Watt Δt 50° x 1,264
Watt Δt 40° = Watt Δt 50° x 0,750
Watt Δt 30° = Watt Δt 50° x 0,518
Watt Δt 20° = Watt Δt 50° x 0,307

p max = 10.0 bar